



**CHICOPEE®**

# Building Care

The complete range of floor and surface  
wiping solutions for your business

Chicopee® True Confidence™



[chicopee.com](http://chicopee.com)

# Total Floorcare Solutions

Complete range of **wiping solutions** to keep your business clean & hygienic

Keeping your building clean and hygienic should be a priority whether it is in a critical care environment, school or office building. This is because the health and well being of all of those inside is critical to the success of each establishment. Good cleaning practises lay at the heart of that, so here are some top tips.

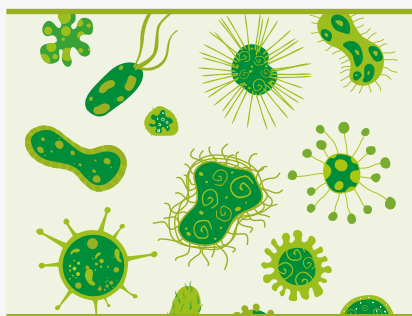

## What is your floorcare routine?

Dust might seem like an innocuous substance, **but most people don't realise that 80% of all dirt in buildings is dust.** And dust is unfortunately a breeding ground for all known micro-organisms, and therefore a key risk area. The traditional and still most common solution to this is wet mopping, which on the surface might seem like a suitable solution but research suggest otherwise.

## Combining dry and wet mopping for maximum results

### Out with the old, in with the new

Bacteria need moist, nutrition and warm temperatures to grow, very similar to those provided by traditional wet mopping. Research shows that wet mopping of floors stimulates the multiplication of micro-organisms including the MRSA bacteria, because they feed predominately on dust. Research has also concluded that countries where dry dusting is a common practice before wet mopping have a very low MRSA infestation rate, and vice versa for those who wet mop without dry dusting first.

## Consistent cleaning

So you have the right process, but how do you ensure its used correctly, here is some helpful guidance

- ✓ Start your cleaning by dusting the highest surfaces like cupboards, topside of doors, to ensure the best hygienic result. Then move to clean the lower surfaces like tables, window-sills, bed side tables, to remove dust and dirt
- ✓ Start all of your mopping on the outside of the room, then move to the centre area (as shown in the diagram to the right)
- ✓ Overlap wiped areas by 25% to ensure all surface areas are thoroughly mopped
- ✓ Always wipe from the overlap point and pull cloth towards yourself
- ✓ Train staff on the basic reasons for conducting dry mopping followed by wet mopping, education and understanding is key to success
- ✓ Always use the correct cleaning wipe for the task at hand

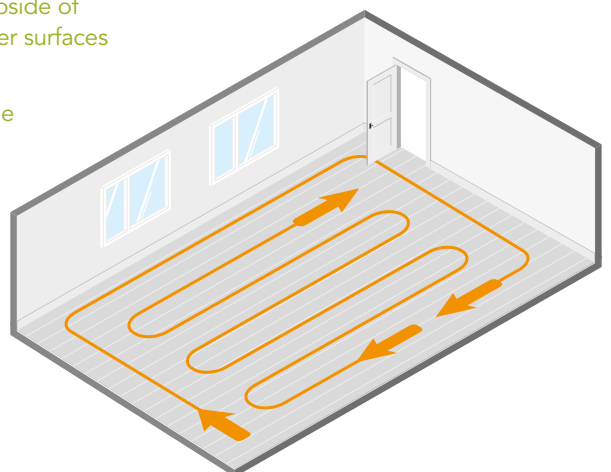

# Solutions to ensure minimal effort and maximum results

## Choosing the right floor wipe for your operation

Chicopee offers a wide range of floor and surface wipes, from Tack and Oil-impregnated to short term use microfibre mops. See some of the great features and benefits below, and use the table to help select the right floor product for your cleaning needs.

| Product Information    |             |            | Performance         |              |              | Recommended Tool |           |
|------------------------|-------------|------------|---------------------|--------------|--------------|------------------|-----------|
| Name                   | Type        | Cleaning   | Dual Sided Cleaning | Surface Area | Dirt Pick Up | Extension Mop    | Fluid Mop |
| Floor Wipe Economy     | Dry Dusting | Oil        | -                   | 8m2          | ●            | ✓                | -         |
| Stretch n Dust Light   | Dry Dusting | Oil        | -                   | 20m2         | ● ●          | ✓                | -         |
| Duster Plus            | Dry Dusting | Tack       | ✓                   | 35m2         | ● ● ●        | ✓                | -         |
| Stretch n Dust Heavy   | Dry Dusting | Oil        | ✓                   | 50m2         | ● ● ●        | ✓                | -         |
| Microfibre Mop Economy | Wet Mopping | Microfibre | -                   | 50m2*        | ●            | -                | ✓         |
| Microfibre Mop Light   | Wet Mopping | Microfibre | -                   | 75m2*        | ● ●          | ✓                | ✓         |
| Microfibre Mop Super   | Wet Mopping | Microfibre | ✓                   | 25m2/ 100m2* | ● ● ●        | ✓                | ✓         |

Key ● Good ● ● Better ● ● ● Best

\*Estimated m2 cleaning when using the Chicopee Fluid mop system

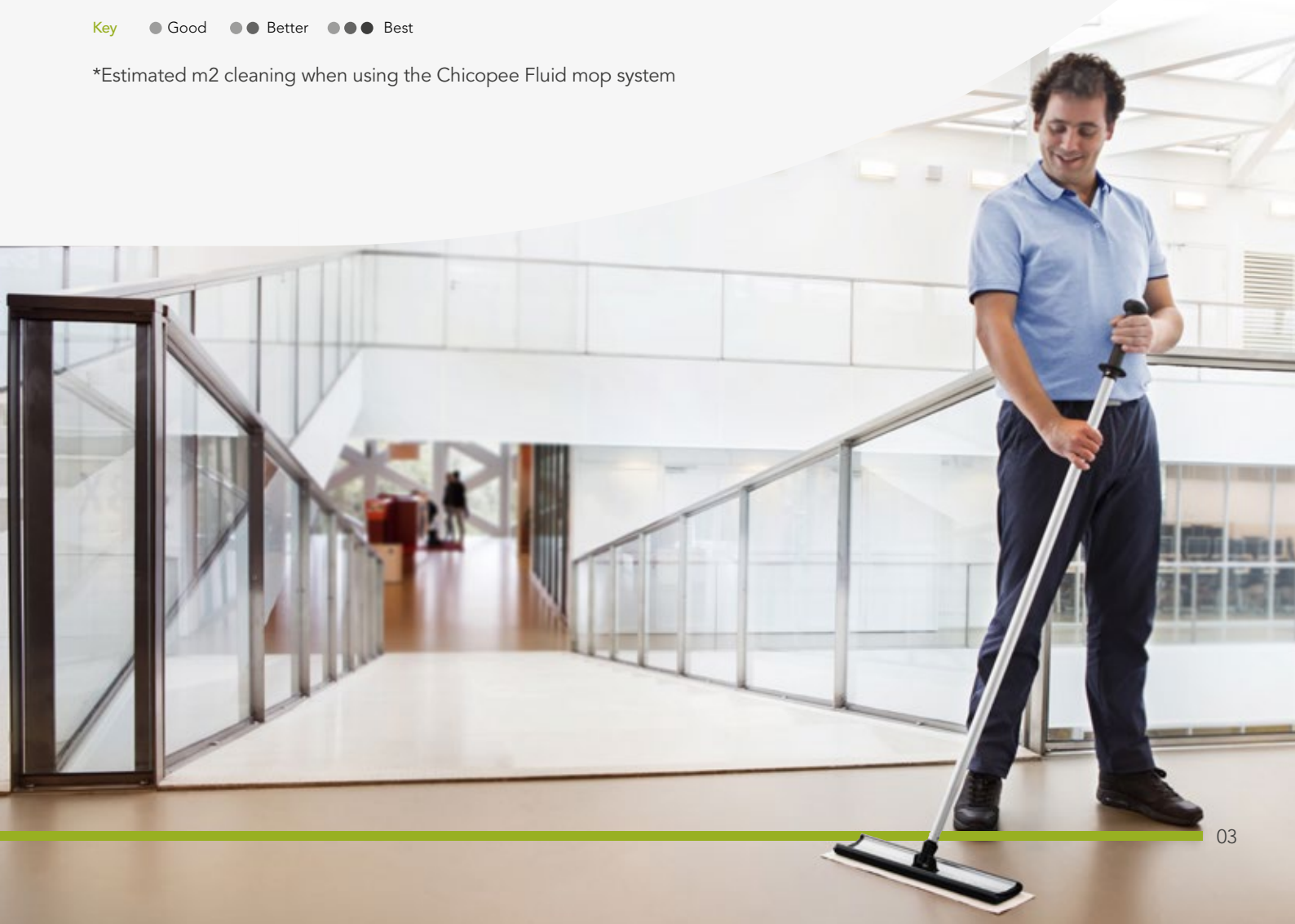



# Dry Dust Mopping

Complete range of oil and tack floor mops to improve hygiene practices

Dust and dirt build-up is inevitable on every kind of hard, smooth floor or surface. Not only unattractive, dust and dirt are unhygienic, and may be the cause of allergies or more serious health and safety problems.

Our unique disposable floor wipe range has several advantages over traditional mopping systems: they have superior dust and dirt pickup, they are environmentally friendly and they ensure a healthy way of cleaning.



## Unique 3D structure

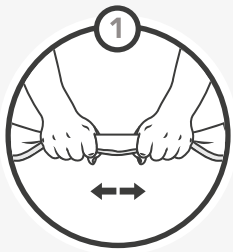

### Stretch & wipe

First stretch the wipe, this creates the 3D structure across the wipe

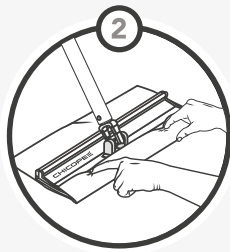

### Attach cloth

Simply attach the wipe in the simple to use zip channel

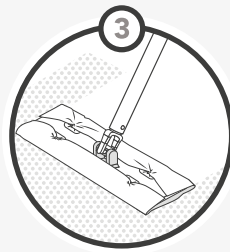

### Clean area

Clean the desired area, remembering no water is needed

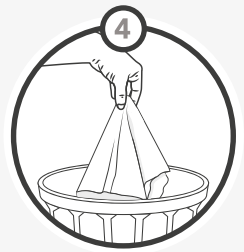

### Disposal

Once the wipe has become filled with dirt and dust simply remove and throw away

Dry dust mopping is a **VITAL STEP** to reduce allergens and bacteria build up



# Impregnated for superior dust collection

## Perfect for public areas where machine cleaning is not possible

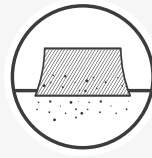

### Dust Pick Up

Engineered to pick up and hold dust, dirt and hair for effective cleaning



### Disposable

Reduce the risk of cross contamination by discarding after use



### Soft

Delicately cleans a range of surfaces, suitable for wood, laminate and tiles

Available in different pack sizes and qualities

## Wide range of product solutions

We have a wide range of products in different weights and with different impregnations. Each designed with a different need in mind. Choose the right solution for your needs to help increase effectiveness and reduce time.

### Single room cleaning

- ✓ Economy Floor Wipe (Oil)

### Hygiene critical areas

- ✓ Stretch n Dust - Light (Oil), Duster - Plus (Tack)

### Large public and commercial open areas

- ✓ Stretch n Dust - Heavy Duty (Oil)

| Article Number | Quality Level | Size cm (L x W) | Sheets Per Pack | Packs Per Case | Product Type |
|----------------|---------------|-----------------|-----------------|----------------|--------------|
| <b>Oil</b>     |               |                 |                 |                |              |
| 73312          | Economy       | 60 x 30cm       | 50              | 20             | Flat Packed  |
| 73153          | Light         | 61 x 30cm       | 50              | 12             | Z Fold       |
| 73201          | Heavy         | 61 x 36cm       | 50              | 8              | Z Fold       |
| <b>Tack</b>    |               |                 |                 |                |              |
| 73158          | Plus          | 43 x 36cm       | 25              | 12             | Z Fold       |

# Hygienic Wet Mopping

Short term use Microfibre mops for increased hygiene

Wet floor mopping has changed a lot since the original string mops. Flat mopping and the increasing use of Microfibre based mops has increased effectiveness, reduced time and lowered chemical consumption.

The focus is now shifting to short term use and disposable microfibre products. The environmental impact as well as the cost of laundering microfibre mops is much higher than most people assume. Switching to a disposable system can further reduce your overall costs as well as improve hygiene practises.



## Designed for use with the Fluid Mopping System

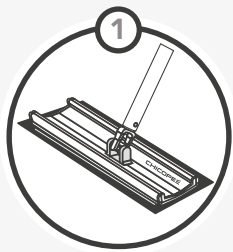

### Attach the mop

Simply place the mop on the floor and it will attach using the micro fastener

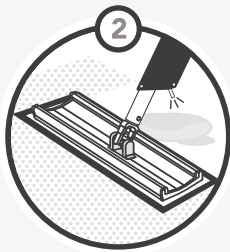

### Spray the floor

Pull the trigger to release cleaning liquid as required

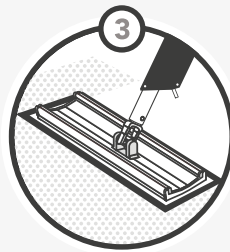

### Clean area

Clean the desired area, remembering to pull the trigger for additional liquid

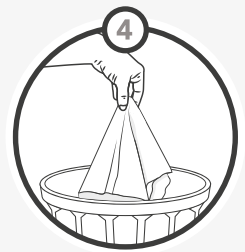

### Disposal

Once the wipe has become filled with dirt simply remove and throw away

By using the Chicopee Fluid Mop System you can **CLEAN OVER 75M<sup>2</sup>** without refilling liquid or changing mops

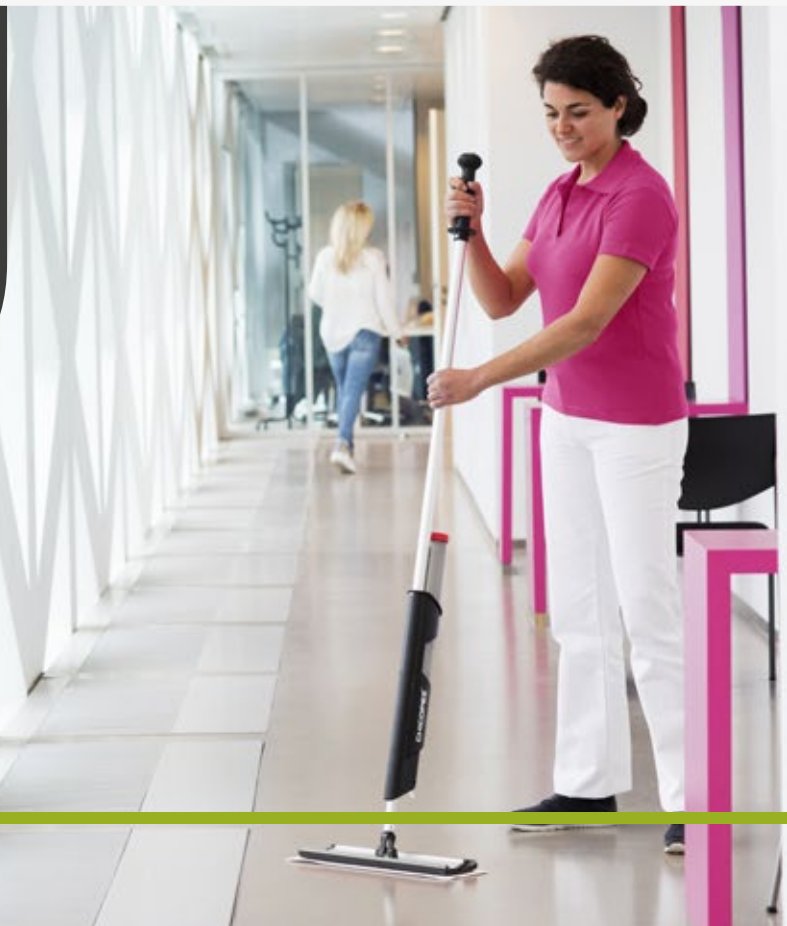

# Reduce cleaning time and remove the need for laundry

## Short term use microfibre mops, for disposal after use

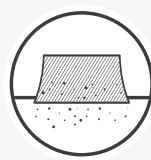

### Dirt Pick Up

Unique microfibre technology captures dirt and bacteria in the mop

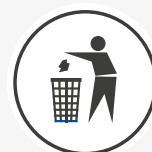

### Disposable

Reduce the risk of cross contamination by discarding after use



### Durable

Designed to match the performance of traditional flat mop systems, disposable does not mean inferior cleaning performance

Available in different qualities

## Wide range of product solutions

We have a range of products dependent on your cleaning routine and area. There are mops designed specifically for our Fluid Mopping System, and mops designed to be pre-impregnated on the cleaning trolley.

### Single room cleaning

✓ Microfibre Mop Economy

### Hygiene critical areas

✓ Microfibre Mop Super

### Large public and commercial open areas

✓ Microfibre Mop Light

| Article Number     | Quality Level        | Size cm (L x W) | Sheets Per Pack | Packs Per Case | Product Type     |
|--------------------|----------------------|-----------------|-----------------|----------------|------------------|
| <b>Floor Mops</b>  |                      |                 |                 |                |                  |
| 74150              | Economy              | 43 x 12.5       | 50              | 10             | Flat Sheet       |
| 74151              | Light                | 43 x 12.5       | 20              | 14             | Flat Sheet       |
| 74152              | Super                | 43 x 12.5       | 15              | 10             | Flat Sheet       |
| 74153              | Light                | 61 x 12.5       | 20              | 10             | Flat Sheet       |
| <b>Floor Tools</b> |                      |                 |                 |                |                  |
| 76500              | Fluid Mop Kit - S    | 132             | -               | -              | Floor Mop Kit    |
| 76580              | Fluid Mop Kit - L    | 152             | -               | -              | Floor Mop Kit    |
| 76720              | Extension Handle     | 100-180         | -               | -              | Floor Mop Handle |
| 76162              | Zip Channel Frame    | 40              | -               | -              | Mop Frame        |
| 76160              | Micro fastener Frame | 40              | -               | -              | Mop Frame        |

# Ergonomic Cleaning Tools

Designed with cleaning staff in mind, for ultimate ease of use

## Chicopee® Fluid Mopping System™

The Chicopee Fluid Mopping System is a simple yet effective way to increase the speed of your floor cleaning process without compromising on quality. With an inbuilt fluid reservoir you can add upto 620ml of floor cleaning solution that can be dispensed as you clean with the simple trigger on the handle.

### Problems

Cleaning professionals need to wet mop "wet clean" floors with the minimum effort and time, but maximum results. Key barriers to this are;

- The amount of liquid a mop can carry (Best woven mops = 20m2)
- The weight of the mop tool itself & durability over time
- The friction resistance of the mop against the floor
- The number of times you have to change a mop itself

### Solutions

- Number of m2 that can be cleaned in one go increases to around 75-100m<sup>2</sup>
- Ensures users do not dislike or reject the tool due to weight, and that it lasts over time
- The design reduces the feeling of weight and the mop head reduces friction
- Easy to attach micro fastener with replaceable frames available



## FLUID SYSTEM ERGONOMICS

Designed to fit the human body

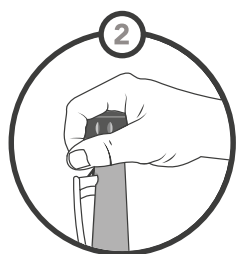

### Design

The design ensures the mop can stand against walls, and does not fall over

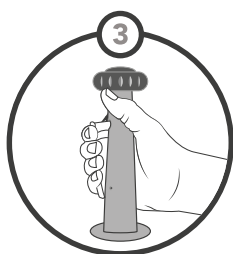

### Large Trigger

Reduces fatigue and the risk of repetitive strain injuries

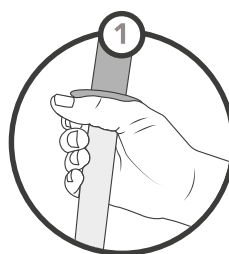

### Lightweight

Ring around base of handle reduces stress when pushing, carrying or using vertically

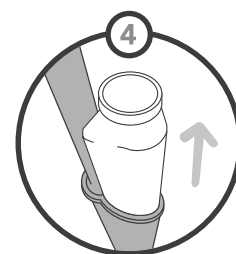

### Easy Refilling

Easy refilling of the liquid reservoir, large open top and removable canister



# Simplicity in design for the ultimate in reliability

## Features and Benefits

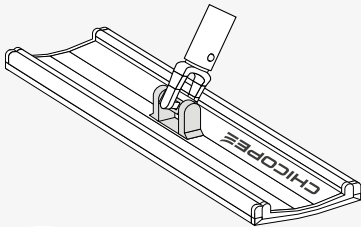

### Handle Protection

Ring around handle base protects trigger if handle is dropped on the floor



### Dry Technology

The Fluid System dry technology valve never touches the cleaning solution, so it's reliable and chemically resistant



### Durable and Flexible

The aluminum core is a unique 1 piece design with thick, 0.9mm side walls for the ultimate in durability yet still flexes to reduce user stress

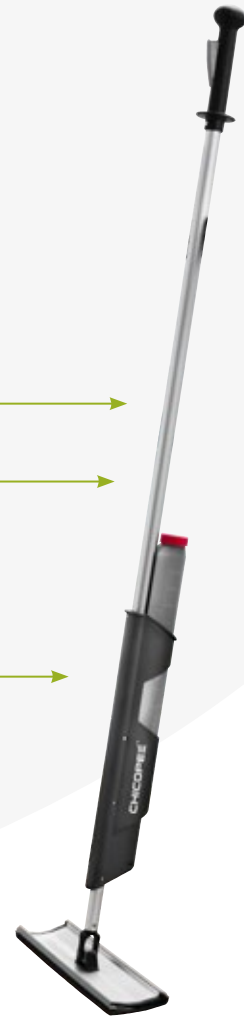

## Fluid System - Built to Last

Designed to be used year after year, the tool is then easily reconditioned with an easy to open plate on the tool. We can supply a System Renewal Kit which contains replacement parts for all wearable items: tube, top cap and bottom cap

| Competitive Comparison   | Chicopee® Fluid Mopping System™ | Rubbermaid Pulse | Impact Mopster | Vileda Professional SprayPro | Private Label System |
|--|---------------------------------|------------------|----------------|------------------------------|----------------------|
| Ergonomic grip shaped to the human hand for the ultimate comfort         | ✓                               | -                | -              | -                            | -                    |
| Large, ergonomic trigger to reduce stress on user's hand when activating | ✓                               | -                | -              | -                            | -                    |
| Multiple sizes for different size users                                  | ✓                               | ✓                | -              | -                            | ✓                    |
| Removable reservoir for quick refills or changing cleaning solution      | ✓                               | -                | ✓              | -                            | -                    |
| Multiple color refill reservoir/caps for color coding                    | ✓                               | -                | -              | ✓                            | -                    |
| Durable one piece central aluminum core construction                     | ✓                               | -                | -              | -                            | -                    |
| Dry valve technology for the best chemical resistance - even bleach      | ✓                               | -                | -              | -                            | -                    |
| Integrated trigger protector in case tool falls to the floor             | ✓                               | -                | -              | -                            | -                    |

# Total Surface Cleaning Solution

Complete range of **wiping solutions** to keep your business clean & hygienic

Much of the same logic as for floor cleaning applies to above the floor cleaning (Surface cleaning). But crucially the risk of cross contamination and the spread of germs and bacteria is far higher with surface cleaning thanks to the high number of touch points.

## How do you clean surfaces?

This might seem like a simple question, but for many people it is overlooked. It is first important to determine what you want to achieve;



Clean Surfaces



Sanitised Surfaces



Disinfected Surfaces

## Utilise the right products to save time and money

If you are looking to sanitise or disinfect your surfaces then it is vital you clean them first.

Applying a cleaning chemical to an already soiled surfaces is a very common mistake. Surfaces must be clean before they can be sanitised or disinfected.

This is because chemical application should be seen as just that, it is the application of a chemical to create a thin layer of residue which dries naturally.

Some disinfectants require upto 5 minutes of dwell time to effectively disinfect the surface.

## Clean first, application second

Once you have decided what level of wiping and cleaning is required it will make your product choice much easier.

We offer a range of products to make tasks easier and therefore reduce worker time, which after all is by far the highest cost in cleaning;

- ✓ **Duster Plus** - Tack impregnated for quick, clean and chemical free dry dusting of all surfaces
- ✓ **Microfibre Range** - Not like your normal microfibres, we offer short term use products, they look and feel like cloths, but simply throw them away after a shift or a day, reducing laundry costs and simplifying your process

# Solutions to ensure minimal effort and maximum results

## Choosing the right wipe for your operation

Below we have tried to create a simple to use matrix to showcase our leading building care products for surface wiping. If you require a product which you can not see below then please just get in touch to see if we have something else for the job.

| Product Information        |                 |           |          | Performance |              |          |
|----------------------------|-----------------|-----------|----------|-------------|--------------|----------|
| Name                       | Type            | Usage     | Washable | Durability  | Dirt pick up | Wipe Dry |
| Microfibre Economy         | Microfibre      | Wet & Dry | -        | ●           | ●●           | ●●       |
| Microfibre Light           | Microfibre      | Wet & Dry | -        | ●●          | ●●●          | ●●●      |
| Microfibre Plus            | Microfibre      | Wet & Dry | ✓        | ●●●         | ●●●          | ●●●      |
| Duster Plus                | Tack            | Dry       | -        | ●           | ●●●          | -        |
| J-Cloth Plus Biodegradable | Biodegradable   | Wet & Dry | -        | ●●          | ●●           | ●        |
| SUDS Multipurpose          | Quat compatible | Wet       | -        | ●           | ●●           | -        |

Key ● Good ●● Better ●●● Best

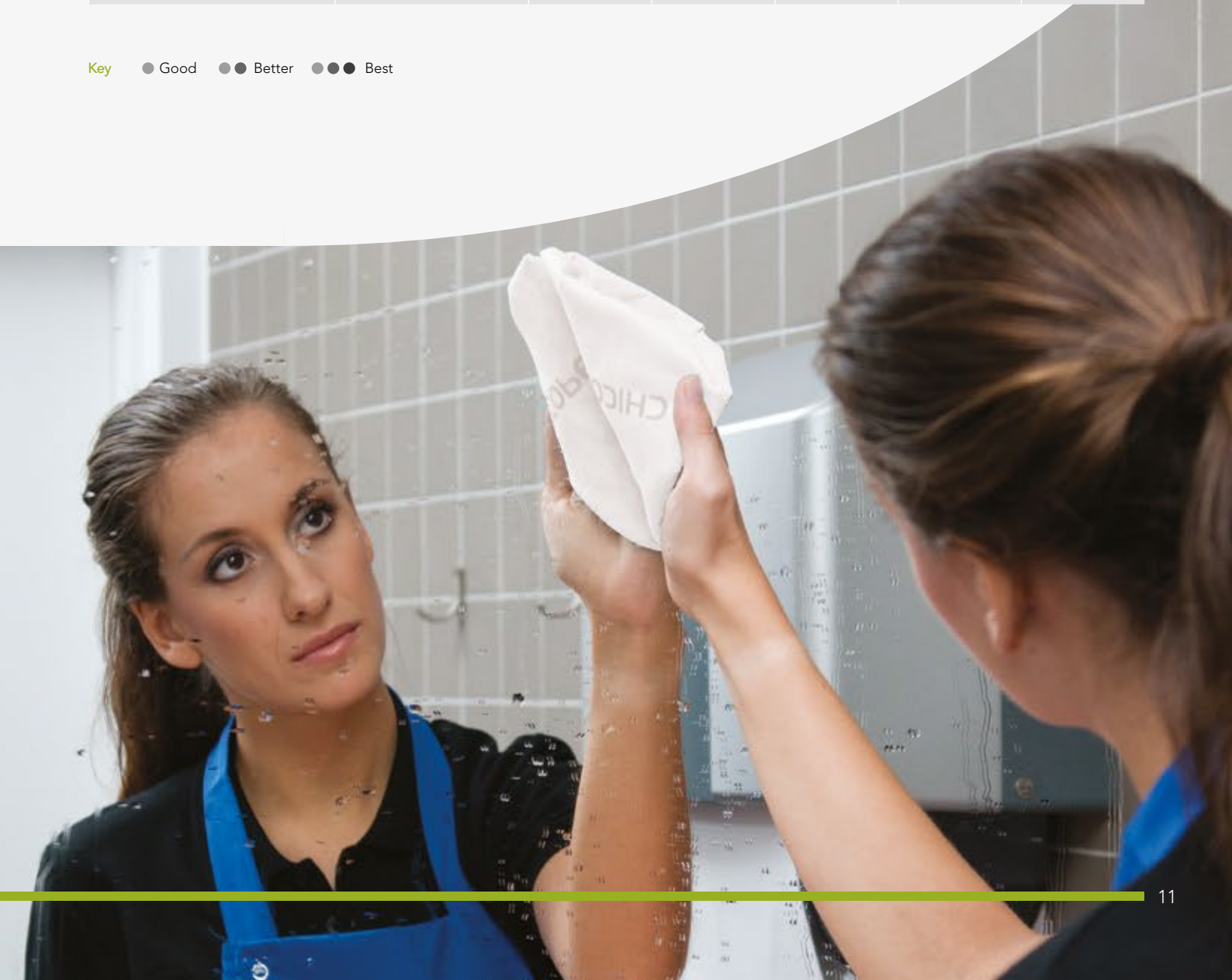

# Microfibre Surface Cleaning

Our unique APEX® technology creates a bulky yet soft and supple cloth

Chicopee Microfibre Light cloth provides the same superior cleaning performance as traditional woven microfibre cloths without the risk of cross contamination. Designed for short term use, it removes the need to launder cloths therefore saving time and improving hygiene practises while still removing 99.99% of bacteria.



## Problems

- A study published in the American Journal of infection control found that 93%\*\* of laundered microfibre cloths still contained dangerous levels of bacteria, after washing
- Time is by far the most precious resource in facility cleaning, laundry processes eat up into this valuable resource
- Traditional cloths have been shown to potentially spread over 30%\* of germs they pick up and then deposit them onto the next surface wiped

## Solutions

- Short term use microfibre cloths provide the same 99.99%\* bacteria removal as woven cloths, without the risk of laundry
- Designed to be used for a limited time, Microfibre Light can be disposed of after use, reducing time spent by cleaning staff on non value added tasks
- The unique structure of the Microfibre Light cloth ensures that bacteria are trapped in the cloth and not released onto the next surface



Available in  
**5 COLOUR  
CODED**  
options for easy  
separation of  
cleaning tasks





# Superior cleaning with 99.99% bacteria removal

## Features and Benefits





**Removes 99.99% bacteria**  
From surfaces, improving hygiene



**Cleaning Agents**  
Compatible with all cleaning agents



**Wipes Dry**  
Wipes surfaces dry to leave them perfectly clean



**Safe for use on touchscreen**  
Provides streak free cleaning on touchscreens



**Available in 5 colour coded options**  
Suitable for all cleaning tasks

## Powerful cleaning on all surfaces

Our unique structure provides quick and easy cleaning of many modern tricky to clean surfaces, without chemicals.



Innox



Glass



Touchscreens

| Article Number | Colour Print     | Sheet Size (L x W) | Sheets Per Pack | Packs Per Case | Product Type |
|----------------|------------------|--------------------|-----------------|----------------|--------------|
| 74733          | Blue             | 34 x 40 cm         | 40              | 8              | 1/4 Fold     |
| 74737          | White - No Print | 34 x 40 cm         | 40              | 8              | 1/4 Fold     |
| 74736          | Green            | 34 x 40 cm         | 40              | 8              | 1/4 Fold     |
| 74735          | Yellow           | 34 x 40 cm         | 40              | 8              | 1/4 Fold     |
| 74734          | Red              | 34 x 40 cm         | 40              | 8              | 1/4 Fold     |

\* Externally certified to officially documented test methods to produce a 4 log removal of S.aureus and E.Coli from a stainless steel surface, transferring 0 percent to a second surface

\*\* American Journal of Infection Control, Laura Y. Sifuentes, PhD et al, 41 (2013) 912-5

# Surface dusting

The perfect solution for capturing dust, dirt and hair from surfaces

Innovative tack **TECHNOLOGY**  
traps dust quickly and easily,  
perfect for **SENSITIVE SURFACES**

No amount of dust can escape the innovative Duster Plus wipe. Duster Plus wipes are specially designed with a pressure-sensitive tackifier, a gluey substance on the wipe that traps dust effectively without leaving residue on surfaces or on your hands. The wipe also features a unique open structure that captures the dust in the wipe and keeps it there.



## Problems

- Normal dry wipes don't capture the dirt and dust particles but just whirl them around, resulting in bacteria spreading
- Nearly all known micro organisms can be found in dust and find it nutritious, almost 80% of all dirt in buildings is dust
- Tack based wipes often leave residue and marks on a surface or hands after wiping, causing sticky surfaces and hands

## Solutions

- The wipe features a unique open structure that captures the dust in the wipe and keeps it there preventing dust and dirt to be spread
- The Duster Plus wipes have an excellent dust pick-up to remove all dust, dirt and lint particles from the surface, leaving a perfect dust-free surface
- Duster Plus is user friendly and ideal for any surface without leaving residue on surfaces or your hands

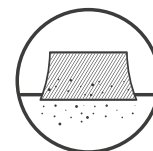

Dust Pick-Up



Silicone Free



Negligible Static

| Article Number | Size cm (L x W) | Sheets Per Pack | Packs Per Case | Product Type | Dispenser |
|----------------|-----------------|-----------------|----------------|--------------|-----------|
| 73158          | 43 x 36 cm      | 25              | 12             | Z Fold       | D2        |

# Unique cleaning solutions

Unique products to solve everyday cleaning tasks

## J-Cloth® Plus Biodegradable

### The most effective green cleaning solution

The unique design and product features of the J-Cloth® Plus Biodegradable are based on the most renowned cleaning wipe, the J-Cloth® Plus. Its unique, open, wavy texture enables efficient pick-up of any dirt and makes it easy to rinse, ensuring longer freshness. In addition, this cleaning wipe is both compostable and biodegradable in accordance with the DIN EN 13432 200-12 standard.

- J-Cloth® Plus Biodegradable has a **unique, open, wavy texture** that enables efficient pick-up of any dirt to deliver the most effective green cleaning solution
- Because the J-Cloth® Plus Biodegradable is **compostable and biodegradable** it ensures environmentally aware waste management
- The unique open structure ensures **maximum dirt collection**, whilst being easily rinsable, ensuring wipes stay fresh for longer



FCC



Biodegradable  
& Compostable

| Article Number | Sheet Size (L x W) | Sheets Per Pack | Packs Per Case | Product Type | Dispenser |
|----------------|--------------------|-----------------|----------------|--------------|-----------|
| 74443          | 43 x 32 cm         | 50              | 10             | 1/4 Fold     | D4        |
| 74442          | 43 x 32 cm         | 50              | 10             | 1/4 Fold     | D4        |
| 74444          | 43 x 32 cm         | 50              | 10             | 1/4 Fold     | D4        |
| 74441          | 43 x 32 cm         | 50              | 10             | 1/4 Fold     | D4        |

## Chicopee® S.U.D.S.® Wipes - Single Use Dispensing System

S.U.D.S.® wipes are engineered to provide superior liquid absorption and debris pick-up. Add your own cleaning or sanitizer solution to the roll of wipes in the dispenser to allow for quick and easy cleaning with pre-prepared wet wipes.

- **Chemical compatible** - Designed to be used with a wide range of chemicals
- **Tailored cleaning** - Improving performance and reducing time. Impregnating yourself has shown to reduce the cost vs. pre-saturated wipes\*\*\*

\* All S.U.D.S. cases come with x1 dispenser bucket

\*\* Recommended saturation level per roll is designed as a guidance only, for longer dwell times saturate to a higher level

\*\*\* Customer tests vs leading brand pre-impregnated Disinfectant spunlace cleaning wipes



| Article No | Description                        | Sheet Size (L x W) | Sheets / Roll | Product Type    | Saturation level** |
|------------|------------------------------------|--------------------|---------------|-----------------|--------------------|
| 84620      | S.U.D.S Multipurpose Light - 2 ply | 25 x 30 cm         | 110           | Centrefeed Roll | 1000ml             |



Chicopee® True Confidence™

How else can we help? Get in touch  
to talk about your business

 [chicopee.com](http://chicopee.com)

 +31 (0) 485 398 435

 [europa@chicopee.com](mailto:europa@chicopee.com)

A brand of **Berry** 